

**Product Information**

**Load-Cell Series RC3**



- Standard- or Ex-devices
- Measuring range from 7.5..100 t
- Operating temperature -20..+60 °C
- Accuracy 0.05 %
- Protection class IP67

**Characteristics**

The high power load-cell series RC3 is completely tightly welded made from stainless steel. The cell is specified for industry applications like tanks, silos and weighbridges for heavy load. The load cell was conceived for nominal loads up to 100 t.

**Technical data**

- Power supply**  
 Bridge supply : max. 15 V DC  
 Operating temperature : -40..+60 °C  
 -10..+40 °C compensated range
- Approvals**  
 : ATEX- approval for Ex-area  
 Zone 0, 1, 2, 20, 21 and 22  
 FM approval
- Bridge resistance** : 1150 Ω  
**Output signal** : 2 mV/V, exact sensitivity  
 on the type plate
- Isolation resistance** : >5000 MΩ  
**Accuracy** : 0.05 % , or 0.02 %  
**Repeatability** : <0.025 %  
**Zero unbalance** : <5 %  
**Max. overload** : 200 %  
**Breaking load** : 300 %  
**Connection cable** : 12 m model size 01, AWG 24  
 18 m model size 02-05, AWG 20  
 4-pole shielded
- Protection class** : IP68, tightly welded  
**Material** : stainless steel 1.4548  
**Weight** : inclusive package,  
 see ordering code

**Dimensions**

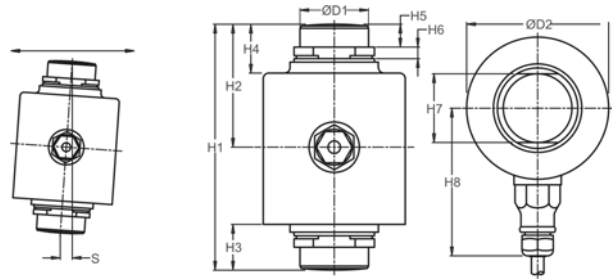

Size	H1	H2	H3	H4	H5	H6	H7	H8	D1	D2	S*	RF**
01	89	44	17	23	11	6	28	75	28	69	8	11
01	89	44	17	23	11	6	28	75	28	69	7	20
01	89	44	17	23	11	6	28	75	28	69	4.5	30
02	140	80	26	28	13	6.5	39	84	39	81	10.5	34
03	150	75	31	33	13	11.7	39	84	39	81	10	37
04	178	89	32	34	17	8.5	44	94	44	99	9	51
05	178	89	38.5	38.5	17	12	62	93.8	62	141.3	11.5	152

\*S<sub>max</sub>: maximum horizontal movement of the load  
 \*\*RF: restoring force at maximum overload or breaking load

**Connection diagram**

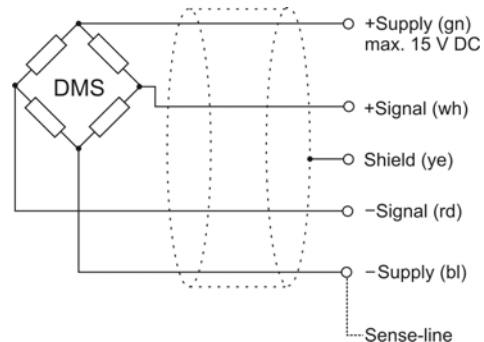

The sense line is used to compensate line resistance from load cell to DMS transmitter. For distances more than 5 m it is recommended to use the sense line.

**Ordering code**

RC3 -  1. -  2. -  3. -  4.

<b>1. Model</b>	00	standard for non-Ex applications
	Ex	Ex applications acc. to KEMA 02ATEX 1123X
<b>2. Model size (see dimensions)</b>	01	7.5..22.5 t / dead load 1.3..1.5 kg
	02	30 t / dead load 3.3 kg
	03	40 t / dead load 3.6 kg
	04	50 t / dead load 4.5 kg
	05	100 t / dead load 4.7 kg
<b>3. Nominal load [t], (look after model size)</b>	7.5 / 15 / 22.5 / 30 / 40 / 50 / 100	
<b>4. Options</b>	00	without option
	01	accuracy 0.02 %